

II
DANBURY QUADRANGLE

N4115-W7315/15
CONNECTICUT

UNITED STATES DEPARTMENT OF THE INTERIOR

GEOLOGICAL SURVEY

1927 N.A.D. - Prelim. Adj.

Transit traverse by R. C. Darnell, 1949

Plane coordinates are based on Connecticut Lambert System

PRELIMINARY

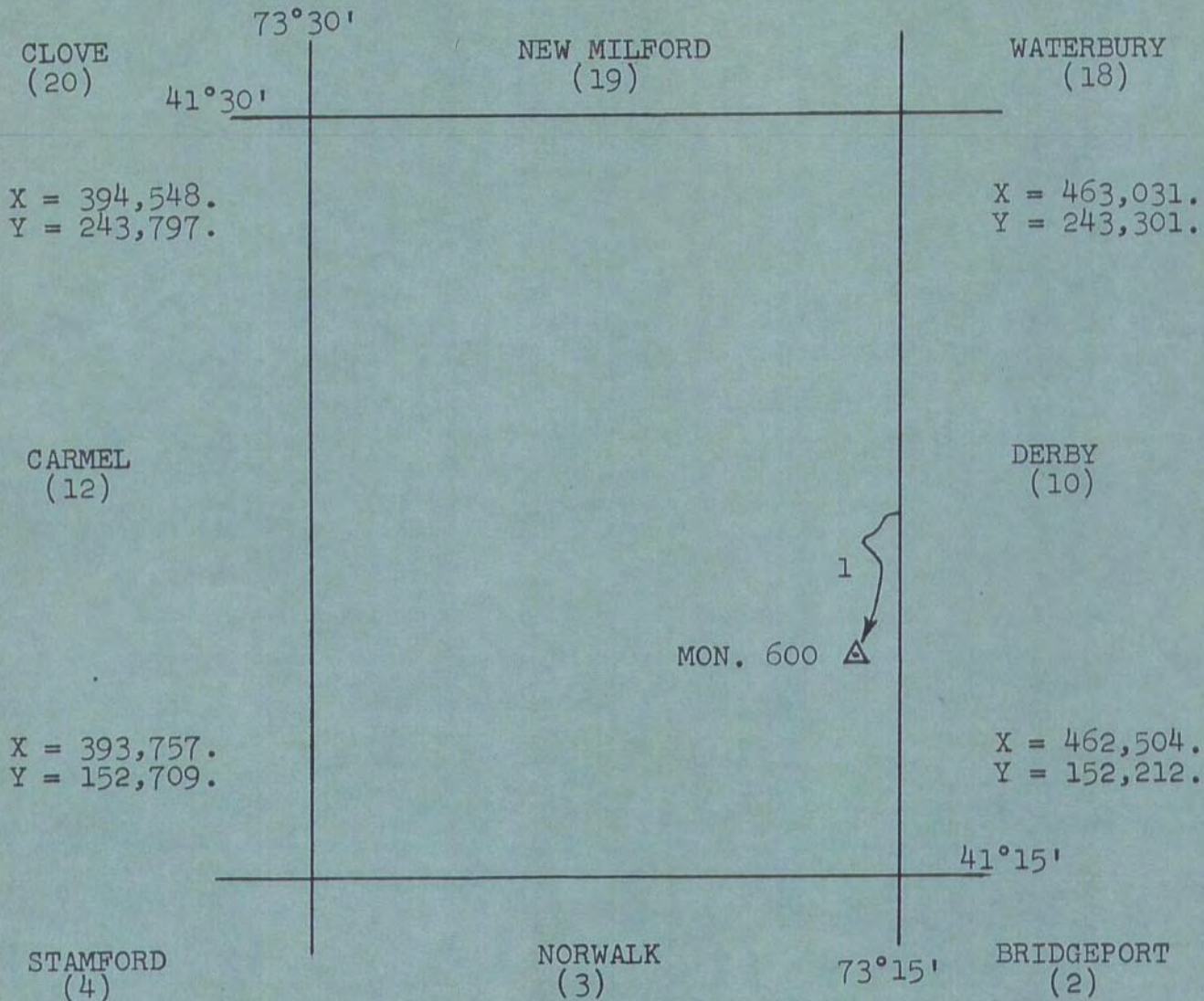

DANBURY QUADRANGLE

CONNECTICUT

INDEX OF PERMANENT MARKS

<u>MARK (USGS)</u>	<u>PAGE NO.</u>	<u>LINE NO.</u>	<u>STA. NO.</u>
4 RS 1949 425	3	1	43A
<u>USC&GS & SS</u>			
199 1935	3	1	48A
600	4	1	63

CONNECTICUT

LINE 1.

DANBURY QUADRANGLE ³

Bks. AH 151 a (fld.)
 AH 152 a (cmp.)
 By R. C. Darnell, 1949
 5/8/57 lrm

1927 N.A.D.
 Prelim. Adj.

40a. Road fork

X = 462,496' Y = 195,049' 41 22 03.24' 73 15 03.35'

42+. Road intersection

X = 460,432' Y = 195,092' 41 22 03.54' 73 15 30.42'

43A. Botsford, 7.2 rails W. of New York, New Haven and Hartford

Railroad station; at rd. underpass; top SW. corner of E.

abutment; standard tablet stamped "4 RS 1949 425" (Not found, 1969)

X = 460,613' Y = 194,581' 41 21 58.51' 73 15 28.01'

43+. Road SE.

X = 460,414' Y = 194,467' 41 21 57.37' 73 15 30.60'

46a. Centerline of crossroad

X = 458,082' Y = 192,931' 41 21 42.06' 73 16 01.07'

48A. USC&GS and State Survey bronze disk stamped "199 1935".

Station is on the NW. side of Highway 25; 4.8 mi S. of junction

with U. S. Highway 6; in Newtown Center. It is 38 ft NW.

of the centerline of hwy., on a bank 10 ft above rd. and in

front of a house owned by Mr. Wildman

X = 458,604' Y = 191,885' 41 21 31.75' 73 15 54.15'

51+. Centerline of rd. and

Newtown town line

X = 459,494' Y = 190,462' 41 21 17.75' 73 15 42.37'

54+. T-road E.

X = 459,865' Y = 188,120' 41 20 54.63' 73 15 37.32'

LINE 1 (Cont'd.)

4
DANBURY QUADRANGLE

1927 N.A.D.
Prelim. Adj.

60+. Private drive W.

X = 458,555' Y = 182,286' 41 19 56.91' 73 15 54.03'

63. USC&GS and State Survey bronze disk stamped "600"; set

in the top of a reinforced concrete post; the station is on

the W. side of State Highway 25, N. of its intersection with

State Highway 59 and 7.3 mi S. of its intersection with

U. S. Highway 6; in Newtown Center. It is in front of property

of Mr. Toth, between the driveway and the house; 50 ft W.

of the centerline of roadway

X = 457,794' Y = 179,550' 41 19 29.83' 73 16 03.80'