

GRANDVIEW POINT  
~~GRAND VIEW NO. 2~~

Lat. 35°45'  
 Long. 111°45'

ARIZONA 395  
 C&GS 35 111 4

(1)	J. T. Stewart	1902-03	9462	(No BM's)			
(2)	"	"	"	(No BM's)			
(3)	"	"	"				
(4)	M. S. Bright	1904	5085				
(5)	E. R. Curtis	1959	PV 364				
(6)	J. R. Hedgpeth	1958	"				
(6)	B. K. Coker	1974	PV 930				

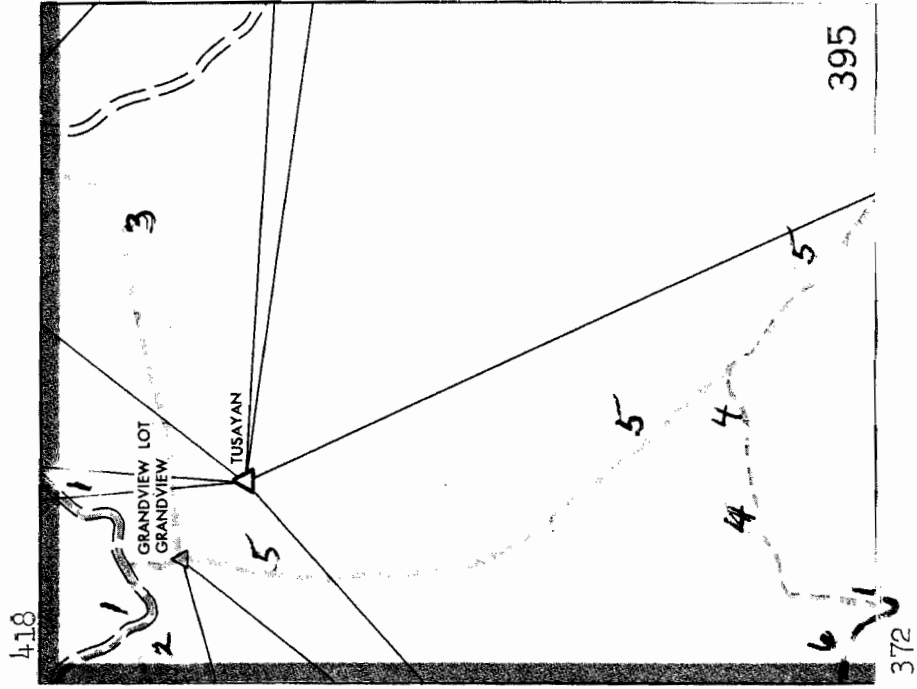

Cocconino County  
Edition of 11/22/65

Only the standard tablets  
are listed for lines run  
more than 25 years before  
the above edition date.

USGS \_\_\_\_\_  
C&GS -----  
C&GS 35 111 4

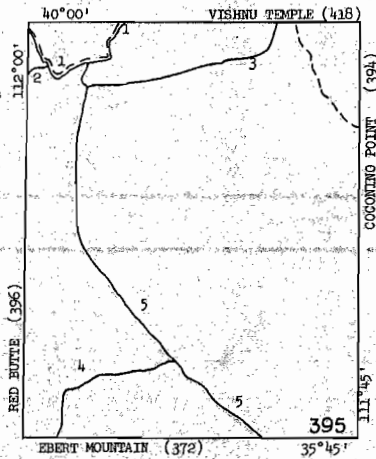

FILE COPY

- Reference mark, 145 ft. S. of tablet, 70 ft. SE. of center of rd., in root on W. side of double pinon pine; copper nail and washer 6374.364
- Curve in large opening, 50 ft. S. of center of rd., rock in place; chiseled square 6430.717
- Valle Airport, 13.5 mi. SE. thence 17.1 mi. N. along dirt rd. toward Bucklar Ranch to a point of trees in a long clearing, 5.1 mi. W. of ranch; 70 ft. E. of a point of trees, 15 ft. S. of center of rd., buried boulder; standard tablet stamped "4 LC 1959 6477" 6477.254
- Reference mark, 80 ft. W. of tablet, 15 ft. S. of center of rd., NW. edge of large pinon pine, buried rock; chiseled point 6476.366
- Top of short, steep rise, 33 ft. S. of center of rd., rock in place; chiseled square 6509.646
- Bucklar Ranch, .3 mi. S. of, 32.7 mi. NE. of Valle Airport to a Y-rd. fork, 64 ft. W. of signboard reading "GRANDVIEW LOOKOUT 15 MILES - BUCKLAR RANCH 3 MILES", 35 ft. N. of center of pinon pine, in bedrock; standard tablet stamped "5 LC 1959 6552" 6552.009
- Reference mark, 170 ft. S. of tablet, 13 ft. SE. of center of rd., in root of W. side of 24 in. ponderosa pine; copper nail and washer 6547.257
- Bucklar Tank, 2.3 mi. S. of, 0.3 mi. NE. of Bloody Tank, 350 ft. SW. of Moqui Tank, 220 ft. E. of rd., on low ridge in flat flint rock; standard tablet stamped "1 JRH 1959 6598" 6598.593

(1) FROM RED BUTTE QUADRANGLE (396) SOUTHEAST TO GRANDVIEW THENCE EAST AND NORTHEAST INTO VISHNU TEMPLE QUADRANGLE (418)

J.T. Stewart, 1902-03 Book: 9462

- Grandview Point, 150 ft. N. of cabin, at W. side of head of trail, in solid limestone ledge under rim; standard aluminum tablet stamped "7406 CANYON" 7400.212
- Grandview, 50 ft. W. of Grandview Hotel; iron post stamped "7496 CANYON" 7489.842
- Hance Ranch, in Sec. 15, T. 30 N., R. 4 E., 150 ft. SE. of old ranch house; iron post with bronze cap stamped "7186 CANYON" 7180.154
- Head of Red Canyon or New Hance Trail, 20 ft. W. of limestone ledge, at rim of canyon; standard bronze tablet stamped "6902 CANYON" 6976.174
- Head of trail, 0.4 mi. N. of, on E. side of trail, in red ledge at foot of cliff; standard bronze tablet stamped "6482 CANYON" 6476.229
- Head of trail, 0.8 mi. N. of, 20 ft. E. and 20 ft. S. of trail, in large sandstone boulder; standard bronze tablet stamped "5882 CANYON" 5975.822

S.F.N.F. 5-85

(5) FROM GRANDVIEW POINT ON SOUTH RIM OF GRAND CANYON SOUTHEAST ALONG PRIMITIVE ROAD INTO EBERT MTN. QUADRANGLE (372) (by J. R. Hedgpeth, 1958; Book [PV 364])

- "Y-61-1934" (USC&GS, Line 61) 7470.562
- Grandview Lookout, 1.3 mi. NW. of, 30 ft. S. of center of highway, 16 ft. E. of rd. to lookout; top of 1 in. iron pipe with "E 10" on side 7466.965
- USC&GS triangulation station disk stamped "GRANDVIEW 1920" Lat.: 35°57'28.136" Long.: 111°57'14.972" 7531.067
- USC&GS reference mark disk stamped "GRANDVIEW 1920" 7530.789
- Grandview Lookout, 1.1 mi. SE. of, 67 ft. NE. of center of rd., in base on SW. side of 24 in. pine; rail spike 7500.904
- Grandview Lookout, 2.3 mi. S. of, 39 ft. W. of center of rd., 19 ft. E. of lone pine, in rock projecting 1 ft. above ground; standard tablet stamped "1 JRH 7434 1958" 7434.458
- Reference mark, 39 ft. S. of tablet, 22 ft. W. of center of rd., in W. root of 24 in. pine; copper nail and washer 7432.558
- Grandview Lookout, 3.2 mi. S. of, at slight curve in rd., 15 ft. W. of center of rd., in base on E. side of 30 in. pine; rail spike 7307.202
- Grandview Lookout, 4.3 mi. S. of, 28 ft. E. of centerline of rd., in flat rock outcrop; standard tablet stamped "2 JRH 7239 1958" 7239.180
- Reference mark, 21 ft. SE. of tablet, on rock; chiseled square 7240.229
- Grandview Lookout, 5.2 mi. SE. of, on flat ridge, 8 ft. SW. of centerline of rd., in base on E. side of 24 in. pine; rail spike 7210.484
- Grandview Lookout, 6.2 mi. SE. of, 5.4 mi. NW. of Bucklar Tank, at saddle, 70 ft. SW. of and 14 ft. higher than centerline of rd., in rock outcrop; standard tablet stamped "3 JRH 1958 7096" 7095.843
- Reference mark, 58 ft. NE. of tablet, in W. root of 30 in. pine; copper nail and washer 7084.938
- Bucklar Tank, 4.2 mi. NW. of, 110 ft. NE. of and 8 ft. higher than old railroad cut through saddle, 76 ft. N. of centerline of rd., 21 ft. E. of 30 in. pine, in flat outcrop; standard tablet stamped "4 JRH 1958 6997" 6997.355
- Reference mark, 20 ft. SE. of tablet, on flat rock; chiseled square 6994.388
- Bucklar Tank, 3.2 mi. NW. of, 235 ft. E. of slight curve in rd., 23 ft. N. of centerline of rd., in S. side of base of 18 in. pine; spike 6880.600
- Bucklar Tank, 2 mi. NW. of, 290 ft. W. of end 19 ft. higher than rd. fork, in flat outcrop; standard tablet stamped "5 JRH 1958 6802" 6801.918
- Reference mark, 102 ft. E. of tablet, in W. side of 24 in. pine; copper nail and washer 6793.571
- Bucklar Tank, 0.7 mi. NW. of, 90 ft. N. of rd. fork, 16 ft. W. of centerline of rd., in E. base of 24 in. pine; rail spike 6737.346
- Bucklar Tank, 340 ft. SW. of pole corral, 290 ft. SW. of center of earth dam, 67 ft. E. of centerline of rd., at sharp curve, 39 ft. SW. of 20 in. pine, in flat outcrop; standard tablet stamped "6 JRH 1958 6683" 6683.547
- Reference mark, 134 ft. SW. of tablet, 27 ft. E. of centerline of rd., in W. root of 15 in. pine; copper nail and washer 6682.218

S.F.N.F. 5-85

(2) NO. BENCH MARKS IN THIS QUADRANGLE.

(3) FROM HANCE RANCH IN SEC. 15, T. 30 N., R. 4 E., EAST TO DEER TANK THENCE NORTH INTO VISHNU TEMPLE QUADRANGLE (418)

M.B. Bright, 1904 Book: 5085

- Hance Ranch, in Sec. 15, T. 30 N., R. 4 E.; iron post with bronze cap stamped "7186 CANYON" (described in Line 1) 7180.154
- Hulls Tank, 2.2 mi. E. of, at N. side of canyon, 20 ft. N. of rd., in limestone ledge; standard aluminum tablet stamped "6805 CANYON" 6798.418
- Hulls Tank, 5.2 mi. E. of, on slight N.-S. ridge, 5 ft. N. of rd., in limestone outcrop flush with ground; standard aluminum tablet stamped "6693 CANYON" 6686.229
- Deer Tank, 1 mi. W. of, in loop of rd. on W. side of small draw, in limestone outcrop; standard aluminum tablet stamped "6688 CANYON" 6682.122

(4) FROM EBERT MTN. QUADRANGLE (372) NORTH TO A POINT 2.3 MILES SOUTH OF BUCKLAR TANK (by L. R. Curtis, 1959; Book PV 364)

- Valle Airport, 13.5 mi. SE. of along county rd. to Spring Valley Rd. junction, thence N. and E. 13.5 mi. to a Y-rd. E. and W., 0.8 mi. NE. of National Forest boundary, 100 ft. S. of Y-rd., 15 ft. E. of center of rd. opposite cedar tree, in concrete post; standard tablet stamped "2 LC 1959 6431" 6431.201
- Reference mark, 90 ft. SE. of tablet, 110 ft. E. of rd., 33 ft. E. of trail, flat rock; chiseled square 6431.351
- At forks of three drains and junction of trail with rd., 48 ft. E. of center of eastmost rd., near bushy pinon pine, rock in place; chiseled point 6393.576
- Valle Airport, 13.5 mi. SE. of along county rd. to the Spring Valley Rd. junction, thence 15 mi. N. and E. along dirt rd. to a Y-rd. junction at New Automobile Tank, about 5 mi. W. of Moqui Tank, 15 ft. N. of center of rd. E., 25 ft. SE. of center of rd. N., in concrete post; standard tablet stamped "3 LC 1959 6367" 6367.518

Bucklar Tank, 0.9 mi. S. of, on point of flat ridge, 31 ft. W. of bend in rd., 29 ft. E. of 30 in. pine, on flat rock; chiseled square	6643.795
Bucklar Tank, 2.3 mi. S. of, 0.3 mi. NE. of Bloody Tank, 350 ft. SW. of Moqui Tank, 220 ft. E. of rd., on low ridge, in flat outcrop; standard tablet stamped "1 JRH 1959 6598"	6598.593
Bucklar Tank, 3.3 mi. SE. of, in low saddle, 46 ft. N. of centerline of rd., in W. root of 20 in. juniper; copper nail and washer	6652.426
Bucklar Tank, 4.5 mi. SE. of, on S. end of low flat ridge, 47 ft. N. of and 13 ft. higher than centerline of rd., in outcrop; standard tablet stamped "2 JRH 1959 6617"	6617.293
Reference mark, 120 ft. E. of tablet, 41 ft. S. of centerline of rd., on rock; chiseled square	6610.852
Bucklar Tank, 5.5 mi. SE. of, 70 ft. S. of centerline of rd., on rock; chiseled square	6601.372
Bucklar Tank, 6.5 mi. SE. of, 2.8 mi. NW. of Lockwood Tank, in low saddle, 57 ft. SW. of centerline of rd., in flat outcrop; standard tablet stamped "3 JRH 6551 1959"	6551.394

FILE COPY

GRANDVIEW POINT (395)

Arizona

J.T. Stewart, 1902-03

Third Order

Adjusted Elevations Based  
On Sea Level Datum of 1929

Book: 9462

Latitude 35°45' Longitude 111°45'

- (1) FROM RED BUTTE QUADRANGLE (396) SOUTHEAST TO GRANDVIEW THENCE EAST AND NORTHEAST INTO VISHNU TEMPLE QUADRANGLE (418)

Grandview Point, 150 ft. N. of cabin, at W. side of head of trail, in solid limestone ledge under rim; standard aluminum tablet stamped "7406 CANYON"

SFNE  
Q-1165  
1985

7400.212

Grandview, 50 ft. W. of Grandview Hotel; iron post stamped "7496 CANYON"

7489.842 OK 1984  
EGE

Hance Ranch, in Sec. 15, T. 30 N., R. 4 E., 150 ft. SE. of old ranch house; iron post with bronze cap stamped "7186 CANYON"

7180.154 OK 198  
EGE

Head of Red Canyon or New Hance Trail, 20 ft. W. of limestone ledge, at rim of canyon; standard bronze tablet stamped "6982 CANYON"

6976.174 OK  
1984  
EGE

Head of trail, 0.4 mi. N. of, on E. side of trail, in red ledge at foot of cliff; standard bronze tablet stamped "6482 CANYON"

6476.229 OK  
1984  
EGE

Head of trail, 0.8 mi. N. of, 20 ft. E. and 20 ft. S. of trail, in large sandstone boulder; standard bronze tablet stamped "5882 CANYON"

5875.822 OK  
1984  
EGE

Head of trail, 1.2 mi. N. of, 15 ft. E. of trail, in very large sandstone rock lying on sloping side of ravine; standard aluminum tablet stamped "5337 CANYON"

5331.127 OK  
1984  
EGE

FILE COPY  
Geodetic Control Unit  
DO NOT REMOVE

FILE COPY

1/2/64 lw ✓

GRANDVIEW POINT (395)

Arizona

M.S. Bright, 1904

Third Order

Adjusted Elevations Based  
On Sea Level Datum of 1929

Book: 5085

Latitude 35°45' Longitude 111°45'

(4) FROM HANCE RANCH IN SEC. 15, T. 30 N., R. 4 E., EAST TO DEER  
TANK THENCE NORTH INTO VISHNU TEMPLE QUADRANGLE (418)

Hance Ranch, in Sec. 15, T. 30 N., R. 4 E.; iron post with  
bronze cap stamped "7186 CANYON" (Described in Line 1)

7180.154

OK 1984  
E.B.E.

Hulls Tank, 2.2 mi. E. of, at N. side of canyon, 20 ft. N. of  
rd., in limestone ledge; standard aluminum tablet stamped  
"6805 CANYON"

6798.418

OK 1984  
E.B.E.

~~Hulls Tank, 5.2 mi. E. of, on slight N.-S. ridge, 5 ft. N. of  
rd., in limestone outcrop flush with ground; standard aluminum  
tablet stamped "6693 CANYON"~~

~~6686.229~~

~~SFWF 1985~~

~~Deer Tank, 1 mi. W. of, in loop of rd. on W. side of small  
draw, in limestone outcrop; standard aluminum tablet stamped  
"6688 CANYON"~~

~~6682.122~~

FILE COPY  
Geodetic Control Unit  
DO NOT REMOVE

FILE COPY

1/2/64 lw *llw*

BENCH MARK DESCRIPTIONS, FIELD SUMMARY

35 112 12  
 UNITED STATES  
 DEPARTMENT OF THE INTERIOR  
 GEOLOGICAL SURVEY  
 9-1128

Page	Quads.	State	By	Altitude by
Bk.—Page	Miles	Adj.	Date	Field Book
	VALLE <sup>395</sup> (373)	Arizona	B.K. Coker,	1974
	Third Order	Field Elevations		
	Book: PV 930	Latitude 35°30' Longitude 112°00'		
e/24	9.51	<p>(6) FROM THE SOUTHEAST EDGE OF RED BUTTE QUADRANGLE (396) EASTERLY INTO THE NORTHWEST CORNER OF <del>EBERT MOUNTAIN</del> QUADRANGLE (372) <sup>GRAND VIEW POINT</sup> 395</p> <p>Tusayan Ranger Station, 14.8 mi S. of, along U.S. Hwy. 180, thence 6.0 mi E. along a (steel tower) transmission line, thence 3.5 mi SE. along a dirt rd.; at a T-rd. E.; 55 ft E. and 34 ft N. of rd. jct.; set on a copper-coated rod inside a 6-inch black pipe; standard tablet stamped "156 BKC 1974 6398"</p> <p>JOGS INTO EBERT MOUNTAIN QUADRANGLE (372)</p> <p>FROM THE NORTHEAST CORNER OF EBERT MOUNTAIN QUADRANGLE (372) NORTH TO A POINT ABOUT 1 MILE NORTHEAST OF NATIONAL FOREST BOUNDARY</p>		6398.392
e/30	11.25	<p>BM "2 LC 1959" (Described in USGS line ___)</p> <p>2 LC prev. elev. 6431.201                  2 LC this run 6431.326                  Closure = +0.125</p> <p>11.25 MILES → 0.168 FT.                  3rd Closure = 0.050 M</p>		6431.326

FILE COPY  
 MAR 17 1975